



- No filter
- No freon
- Maintenance-free
- Water removal rate: 99.99%
- No need for a power supply

**Compressed Air Cleaner**

**WELL AIR®**

Using a Proprietary Collision Separation Method

Patented : Approved by the small and medium-sized business creation promotion law



**WELL AIR** separates and eliminates water droplets that collect at the end of pipes.

## New Concept

### ① Separate the water from compressed air

When water in the air has been converted to water droplets, the WELLAIR mechanically separates and eliminates them.

### ② Processes air at the end of the pipe

Shut-off drains at the end of a plumbing run, just before the working pneumatic equipment.

### ③ No need for maintenance

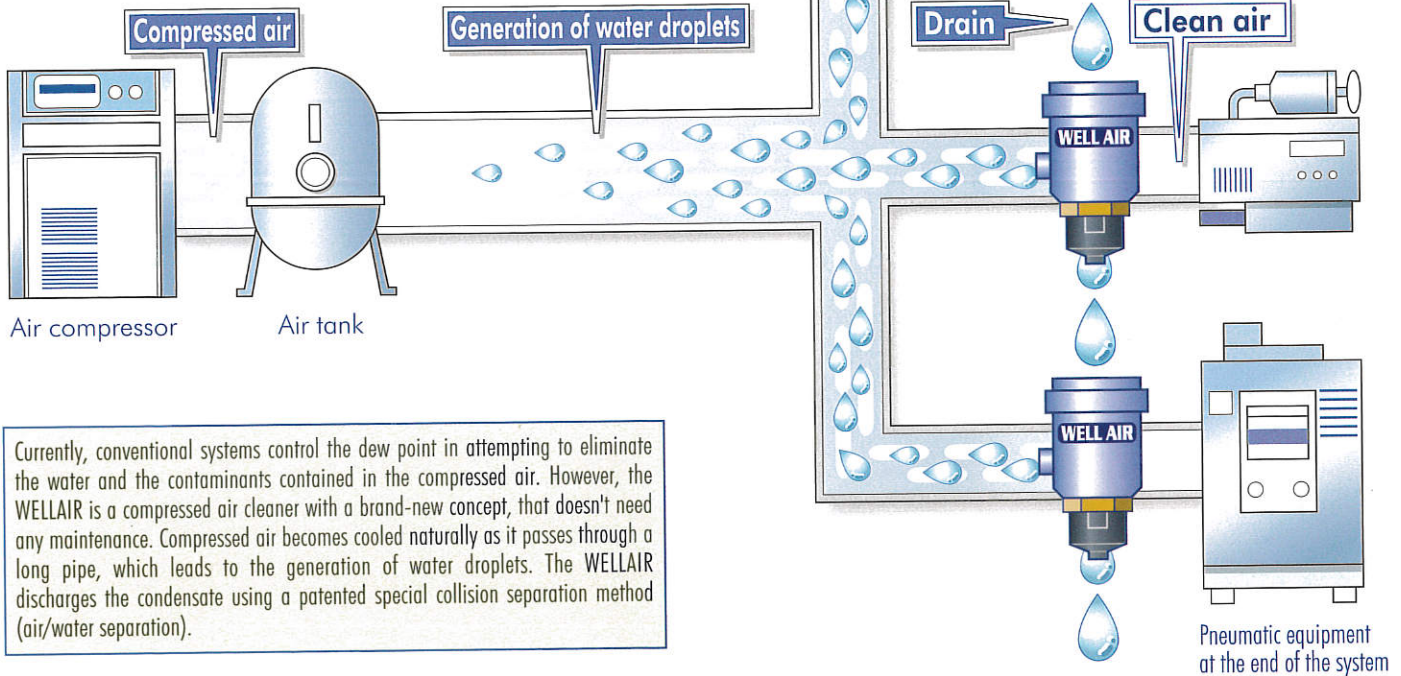

Currently, conventional systems control the dew point in attempting to eliminate the water and the contaminants contained in the compressed air. However, the WELLAIR is a compressed air cleaner with a brand-new concept, that doesn't need any maintenance. Compressed air becomes cooled naturally as it passes through a long pipe, which leads to the generation of water droplets. The WELLAIR discharges the condensate using a patented special collision separation method (air/water separation).

#### Conventional systems

Control dew point  
Single point control

#### WELL AIR

##### Special collision Separation method

① No filter ② No maintenance ③ No need for power

Separate air and water  
Air processed just before use

① Low cost  
② High performance  
③ Compact and light weight

#### Results after installation

Improved uptime for pneumatic equipment

Decreased costs

### What is the patented special collision separation method?

WELL AIR's special collision separation method is a brand-new technology that provides a constant supply of clean air to pneumatic equipment. By taking advantage of the difference in specific gravity between air and contaminants (water droplets, oil, dirt, etc.), the WELLAIR separator uses collision and centrifugal force techniques to continually eliminate 99.99% of any moisture, just by its design.

The system does not need any consumable elements, such as filters or drying agents, nor does it need electric power or refrigerants. Since it continually separates and eliminates contaminants by itself, it needs no maintenance. So there are no operating costs.

Since there is no deterioration in performance, such as happens as a filter becomes clogged, it provides a constant level of high performance.

#### Main drawings

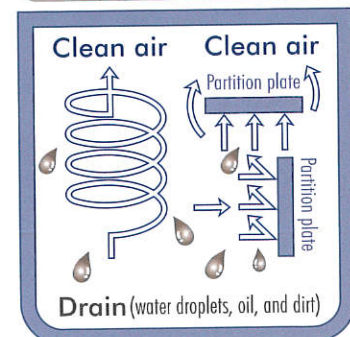

Cyclone system + Collision separation system



# WELL AIR brings you the following advantages.

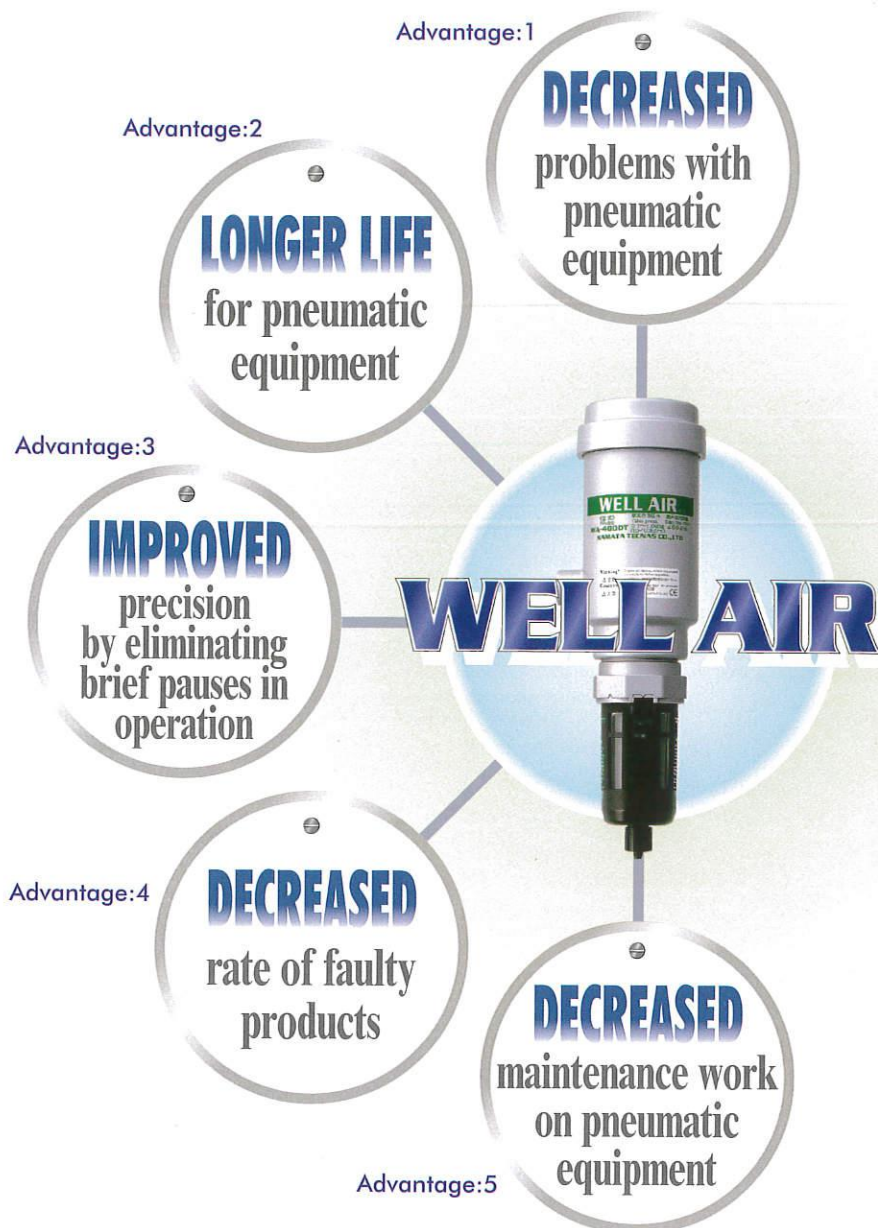

Do you have problems like nuisance maintenance of pneumatic equipment and failures due to unknown causes? Most of these problems are caused by the buildup of contamination (water, oil, and dirt) in compressed air. You can decrease your problems greatly and eliminate nuisance maintenance just by using a WELLAIR.

## Seven major features give you the advantage

- 1** Water removal rate of 99.99%.
- 2** Maintain high performance.
- 3** No need for dew point control.
- 4** No need for filters.
- 5** Does not use freon gas.
- 6** No need for power or refrigerant.
- 7** Compact and lightweight.

# WELL AIR = Continuous high performance.

**Comparison of water separation performance between the WELLAIR and an ordinary filter**

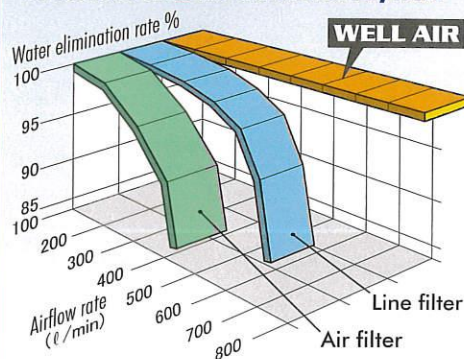

## Water removal test

Aggregate flow rate	50ℓ/min	100ℓ/min	200ℓ/min	300ℓ/min	400ℓ/min	600ℓ/min	800ℓ/min	1000ℓ/min	1200ℓ/min
Pressure	3 Kgf/cm <sup>2</sup>	99.99%	99.99%	99.99%	99.99%	99.99%	99.99%	99.99%	99.99%
	5 Kgf/cm <sup>2</sup>	99.99%	99.99%	99.99%	99.99%	99.99%	99.99%	99.99%	99.99%
	7 Kgf/cm <sup>2</sup>	99.99%	99.99%	99.99%	99.99%	99.99%	99.99%	99.99%	99.99%

※ The water removal tests were carried out by injecting 30 cc of solution, consisting of water and ink, into the WELLAIR inlet at a speed of 30 cc per second.

## Reference Results of an inspection for general bacillus in a compressor's drain

Specimen to be inspected	Inspection item	Inspection result
Drain water in compressor	Number of bacteria	22,000/ml
Water after buffing the air passing through the WELLAIR for 1.5 hours.	Number of bacteria (bacteria in air)	4/ml (Cultured for 48 hours)

※ The WELLAIR is not a sterilizer.

※ The inspection method conforms to the test method for city water (Supervised by the Life Sanitation Bureau of the Ministry of Welfare).

※ Inspected by the Japan Environmental Sanitation Center.



## Options

### ■ Mounting bracket

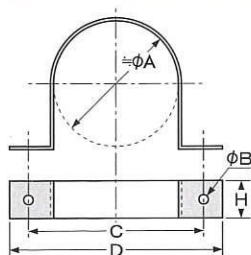

	ØA	B	C	D	H
For the WA-150	65	Ø5	83	105	15
For the WA-400	81	Ø6	116	136	24
For the WA-1200	135	Ø11	173	205	32

Material: Chrome plated SS41

Unit: mm

### ■ Ball valve : M6

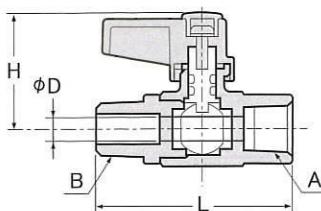
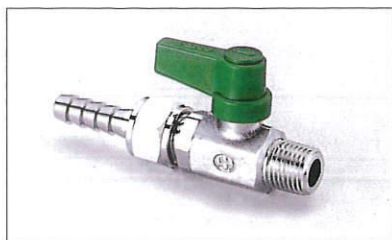

Item name	Nominal diameter	A	B	L	H	ØD
M6-0606	1/8" x 6	R1/8 thread	Ø6	74.3	29	6
M6-0808	1/4" x 8	R1/4 thread	Ø8	78.3	29	6
M6-0809	1/4" x 9	R1/4 thread	Ø9	78.3	29	6
M6-1010	3/8" x 10.5	R3/8 thread	Ø10.5	82.3	29	6

Maximum working pressure: 1.0Mpa=10kgf/cm<sup>2</sup>

Maximum working temperature: -20 to 90°C

Fluids: Cooling water, oil, and air

Test pressure: 0.6Mpa air pressure=6kgf/cm<sup>2</sup>

### ■ Ball valve : ML6

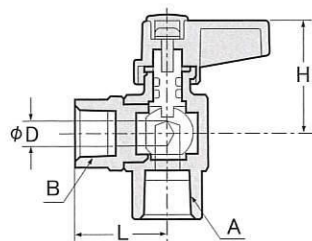
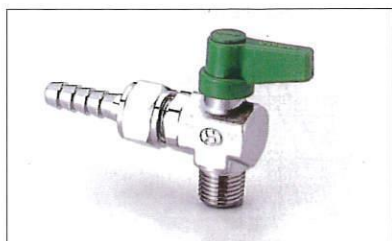

Item name	Nominal diameter	A	B	L	H	ØD
ML6-0606	1/8" x 6	R1/8 thread	Ø6	53.8	29	6
ML6-0808	1/4" x 8	R1/4 thread	Ø8	55.8	29	6
ML6-0809	1/4" x 9	R1/4 thread	Ø9	55.8	29	6
ML6-1010	3/8" x 10.5	R3/8 thread	Ø10.5	62.3	30.5	7.5

Maximum working pressure: 1.0Mpa=10kgf/cm<sup>2</sup>

Maximum working temperature: -20 to 90°C

Fluids: Cooling water, oil, and air

Test pressure: 0.6Mpa air pressure=6kgf/cm<sup>2</sup>

## Precautions when installing the WELL AIR

1. Make sure to install the WELLAIR vertically.
2. Install the WELLAIR just before each piece of pneumatic equipment.  
(Long plumbing runs from the WELLAIR to the working equipment may cause water to condense in the pipe, due to temperature differences between the compressed air and the atmosphere)
3. Make sure to check the air line inlet and outlet.
4. For detailed instructions on the WELLAIR, read the Instruction Manual that comes with the WELLAIR before installing it.
5. Install the pressure-regulator and the lubricator directly in line after the WELLAIR.

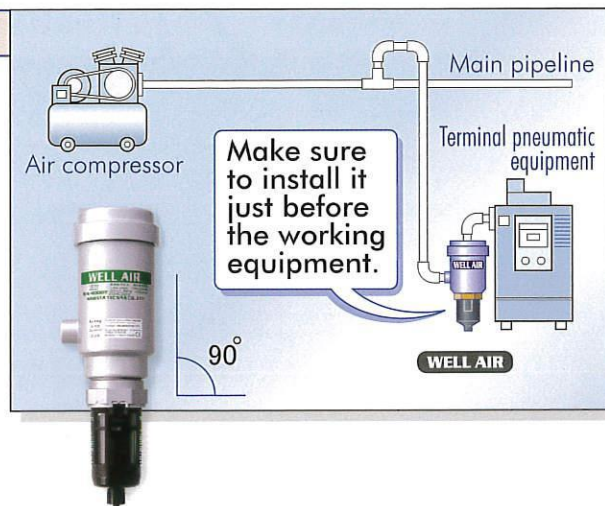

Distributors:

Manufactured by:



株式会社

ナマタテクノス

GRUPO ATS

Ingeniería Logística y Aplicada 8A,  
S. de R.L. de C.V.

Van Gogh #5061 col. Real Vallarta,  
Zapopan, Jal. 45020 México  
Tel.: +52 (33) 4505-5915 y 16



<http://grupo-ats.com/wellair/#>

◆ **DT series****WELL AIR**

It's Effective! To Drain Away Most Of The Dirt &amp; Oil.



※WELL AIR DT series of compressed air purifiers. The auto drain function discharges most of the dirt and oil automatically.

- No filter
- No freon
- Maintenance-free
- Moisture removal rate: 99.99%
- No need for a power supply

Compressed Air Cleaner  
**WELL AIR**  
ウ/ェ/ル/エ/ア/ー

WELL AIR is a revolutionary air compression cleaner that uses absolutely no filters or other components. Our own proprietary collision separation technique (patented) enables WELLAIR to remove as much as 99.99% of the water content from air passing through it.

Model name	WA-150DT	WA-400DT	WA-1200DT
Maximum operating flow rate : Nℓ/min	150	400	1200
Operating pressure range : Mpa(bar)	0.1~1.0(1.0~10.0)		
Guaranteed withstand pressure : Mpa(bar)	1.5(15.0)		
Fluid temperature : °C	5~65		
Drain exhaust section connections, diameter : Rc	hose nipple φ6mm		
Air plumbing connections, diameter : Rc	1/4	3/8	3/4
Weight : kg	0.59	1.11	2.79

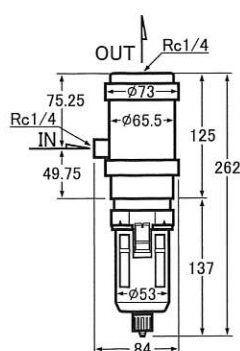
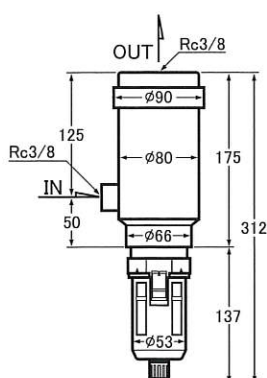
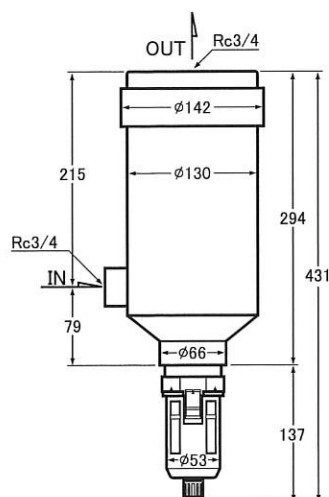
◆ **WA-150DT** ◆◆ **WA-400DT** ◆◆ **WA-1200DT** ◆



# WELL AIR Lineup

**[PRECAUTION]** WELL AIR model selection applies the point of use air requirement, rather than the incoming pipe diameter.

## ◆ HI series

WELL AIR



Model name	WA-150HI	WA-400HI	WA-1200HI
Maximum operating flow rate : Nl/min	150	400	1200
Operating pressure range : Mpa(bar)	0.1~1.6 (1.0~16.0)		
Guaranteed withstand pressure : Mpa(bar)	2.5 (25.0)		
Fluid temperature : °C	5~65		
Drain exhaust section connections, diameter : Rc	1/4		
Air plumbing connections, diameter : Rc	1/4	3/8	3/4
Weight : kg	0.58	1.10	2.79

### • WA-150HI •

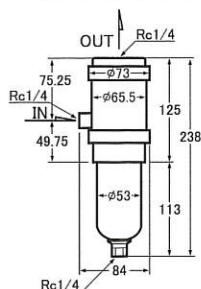

### • WA-400HI •

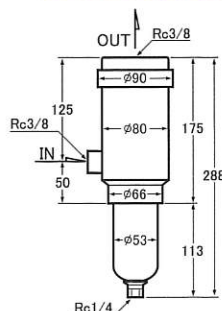

### • WA-1200HI •

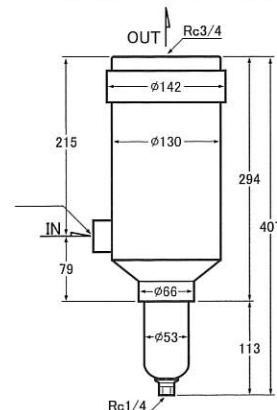

※WELLAIR HI series of compressed air purifiers.  
Medium pressure auto drain type. Can be used  
at pressures up to 1.6Mpa = 16 kgf/cm<sup>2</sup>.

## ◆ RE series

WELL AIR



Model name	WA-400RE	WA-1200RE	WA-2500RE
Maximum operating flow rate : Nl/min	400	1200	2500
Operating pressure range : Mpa(bar)	0.1~1.5 (1.0~15.0)		
Guaranteed withstand pressure : Mpa(bar)	1.5 (15.0)		
Fluid temperature : °C	5~65		
Drain exhaust section connections, diameter : Rc	1/4		
Air plumbing connections, diameter : Rc	3/8	3/4	1
Weight : kg	3.78	5.38	13.10

### • WA-400RE •

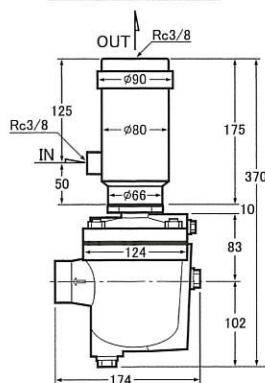

### • WA-1200RE •

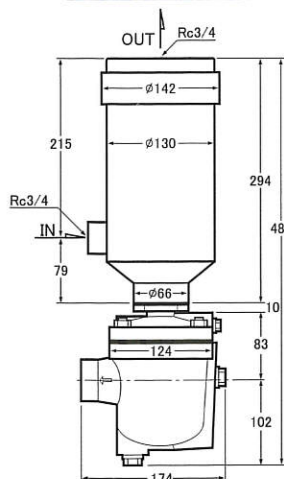

### • WA-2500RE •

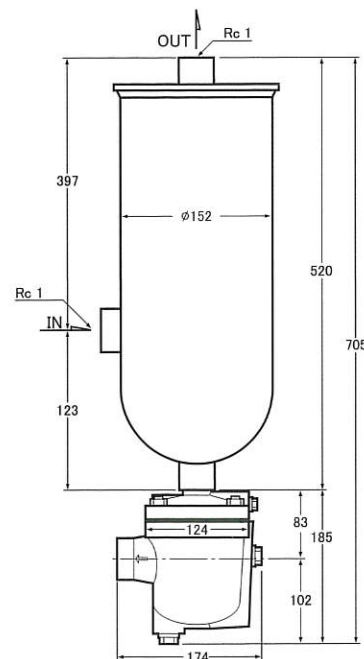

※WELL AIR RE series of compressed air purifiers.  
Equipped with a heavy-duty auto-drain.  
Discharges virtually all the collected contaminants,  
especially dirt and oil.